

# **BARONESS®**

## **Greens Mowers LM56/LM66 Series Installation Manual No.06**

### **Assembly and Installation of Independent Grass Catcher Arm**

---

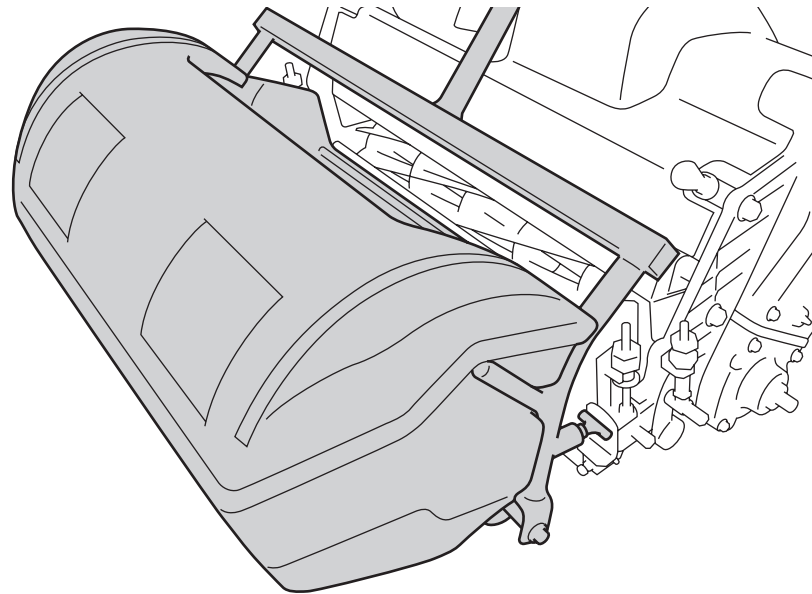

---

Kyoeisha USA Inc.  
[www.baroness.us](http://www.baroness.us)

Please use the following safety precautions when servicing a Baroness mower:

### **Wear protective clothing and gear.**

- Long pants, safety glasses, hard hat, gloves, and steel toe shoes or boots are recommended before doing any work on the greens mower. This will reduce your risk of injury.

### **Notes for installation.**

- Always refer to this installation manual or the owner's manual before beginning any work on the greens mower.
- Be sure to wear protective clothing and gear.
- "Left" and "right" directions in this manual are based on the viewpoint of the operator holding the handle of the mower and facing the mowing direction.
- Before doing any work on the mower, place it on a level surface and make sure all the switches are turned to the OFF position and that all the valves are closed.
- Engage parking brake and block tires while servicing the mower.
- Never attempt to install any parts or make any adjustments while the engine is running.
- Let the engine, muffler, and exhaust system cool before proceeding to service any parts which are in close proximity. These areas can be dangerously hot. Contact with these parts can cause bodily harm and or burns.
- Be mindful and take precaution around of the reel and blades as they contain sharp edges. These can inflict bodily harm and or injury.
- Always keep the safety symbols and instructions clean and attached to the mower. If they are lost or damaged, replace them immediately with new ones.
- Do not alter the machine. When replacing parts and grease, use only those specified by Kyoisha USA.
- The operation of a machine that has been modified or installed with parts other than those specified by Kyoisha USA could lead to mechanical malfunction resulting in damage to the mower and or injury to the operator.

Part	Part Num.	Part Name	Qty
A	LM56G--6801AD	Catcher Arm	1
B	LM56G--6811Z0	IGCA Grooved Roller	1
C	K0021100202	10 Flange Bolt 20	2
D	K0151100002	10 Flange nut	2
E	LM56G--6803Z2	Arm Stopper	2
F	LM56GA-2903Z2	Right Stopper Bracket 2008	1
G	LM56GA-2902Z2	Left Stopper Bracket 2008	1
H	K5012313202	2.3 SPCC Washer 1320	4
I	K6151000152	13 Shaft 76	2
J	K0331300008	13 Snap Pin	2
K	K0300025252	2.5 Cotter Pin 25	2
L	LM56G--6802ZD	Arm Pivot	1
M	LM56G--2901A0	Roller Adjuster Screw 2008	2
N	K6084000162	Roller Adjuster 2008	2
O	K5000080002	8 Washer	2
P	K0213080001	8 Disc Spring Washer	2
Q	LM54G--0801A0	LM56IGCA Grass Catcher	1
R	K4209001230	Alignment Mark 10300	1
S	K4201000110	Baroness Logo Sticker	1

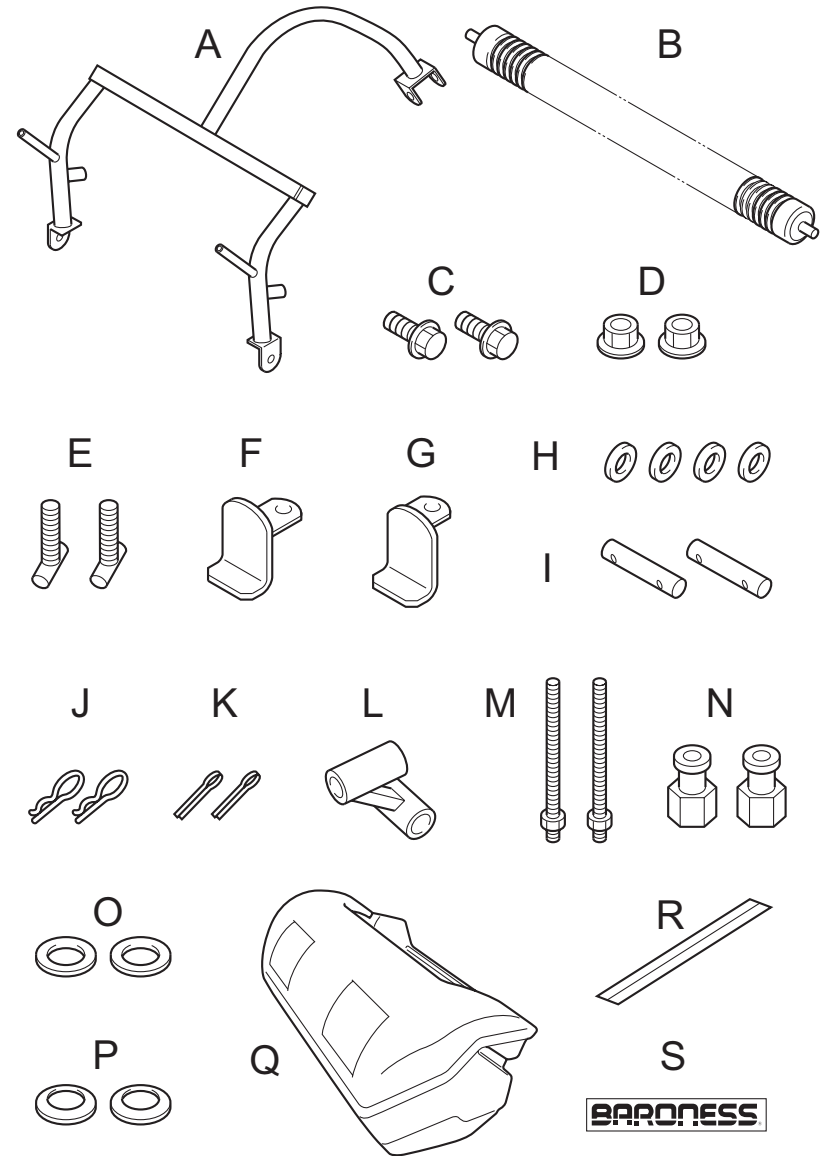

Before adjusting position of Independent grass catcher arm make sure you are working on a flat even surface and that the greens mower is secured, such as properly blocked and or brake is engaged. Tires should be off for proper adjustment of IGCA desired position.

Step 1.

Align roller, Part (B) with allocated holes on the arms of the catcher arm, Part (A).

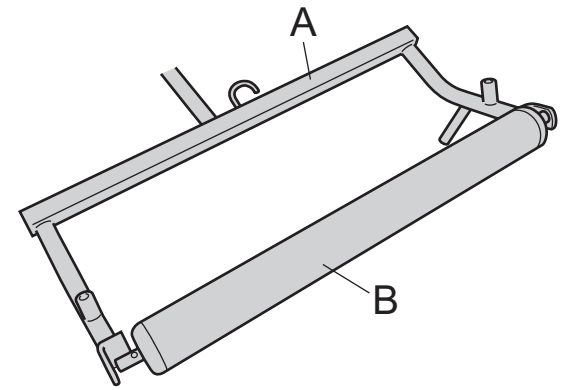

Step 2.

Screw flange bolt, Part (C) through hole on arm of Part (A) and into shaft of roller, Part (B). Repeat for both sides.

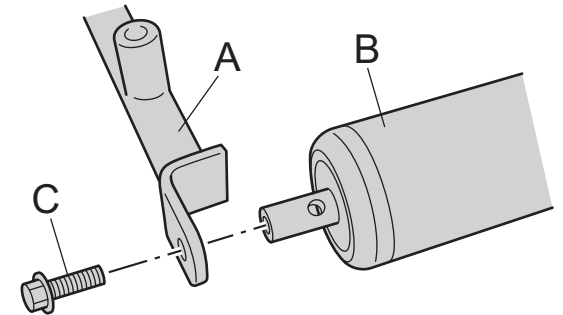

Step 3.

Tighten and lock flange bolt, Part (C). To prevent roller shaft from spinning, slide a screw driver through the hole of the roller shaft and hold for support while tightening bolt, Part (C). Repeat for both sides.

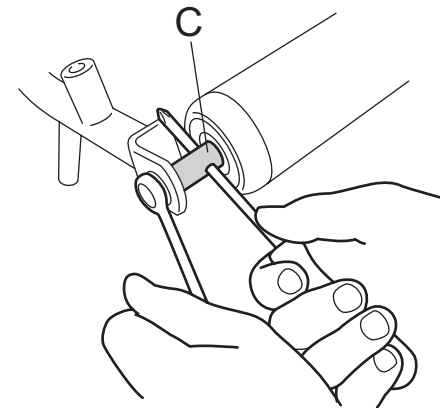

Step 4.

Thread flanged nut, Part (D) onto threaded leg of arm stopper, Part (E). Screw round side of nut on first. Repeat to have a set of 2.

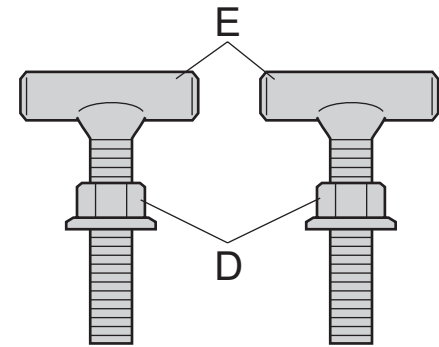

Step 5.

Screw threaded leg of Part (E), into allocated spot on arm of Part (A). Repeat for both sides.

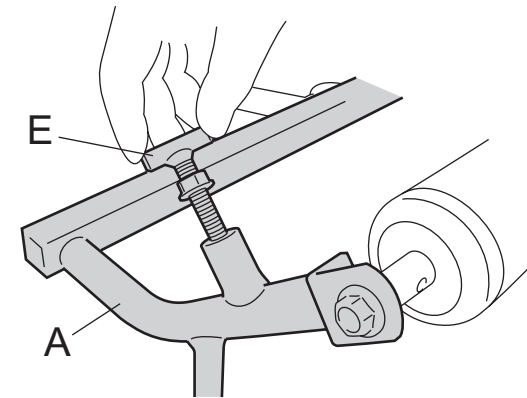

\*\* If green mower does not have left and right stopper brackets installed.

Step 6.

Take roller adjustment screw, Part (M) and tread roller adjuster, Part (N) on the longer threaded side till it is sitting about half way down the tread. The non nut side of Part (N) goes on first. Repeat to have 2 sets.

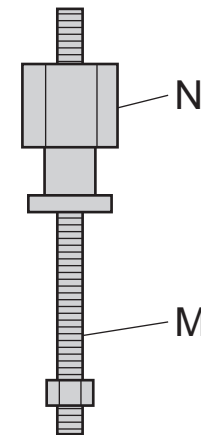

**Step 7.**

Place washer, Part (O) into the cut out slot on the front of the right frame.

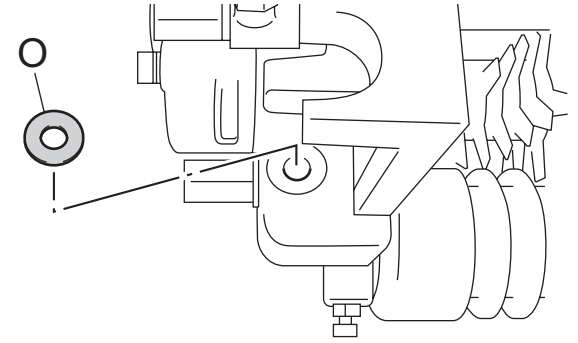
**Step 8.**

Next place right stopper bracket, Part (F) over washer, Part (O).

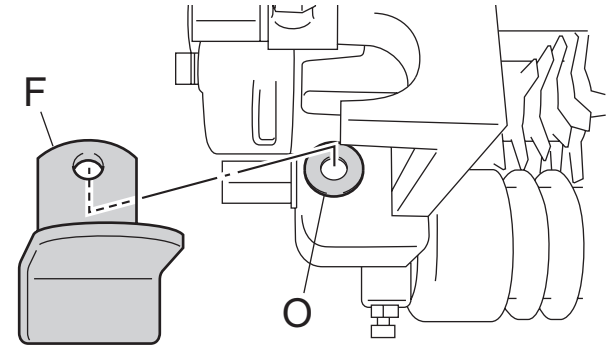
**Step 9.**

Place disc spring washer, Part (P) convex side up over Part (F).

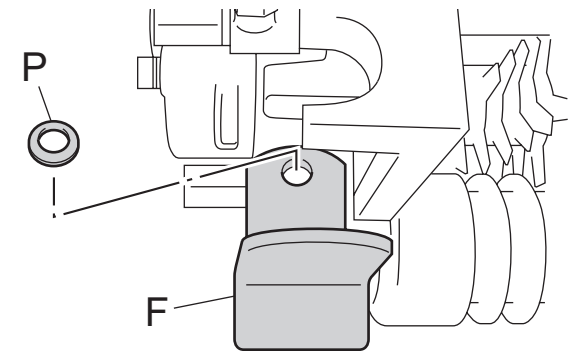

Step 10.

Screw short threaded leg of roller adjustment screw, Part (M) through Parts (O), (F), (P), and then into frame. When doing so, align roller adjuster, Part (N) so that it sits in forked tongue of the right roller bracket arm. Make sure that Part (F) is centered then lock and tighten Part (M) being mindful of the roller adjuster, Part (N) position.

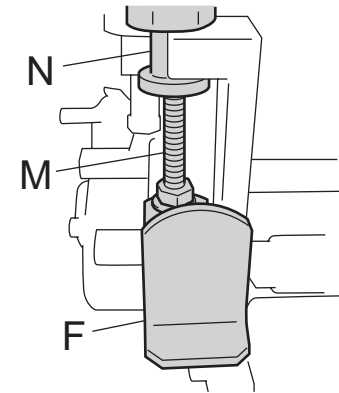

Step 11.

Place washer, Part (O) into the cut out slot on the front of the left frame.

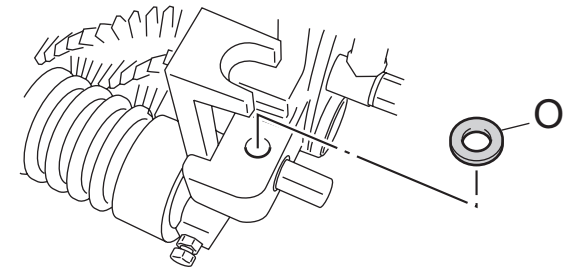

Step 12.

Next place left stopper bracket, Part (G) over washer, Part (O).

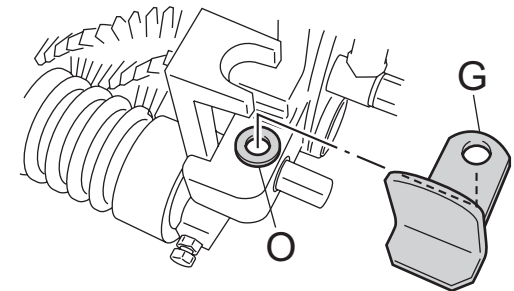

Step 13.

Place disc spring washer, Part (P) convex side up over Part (G).

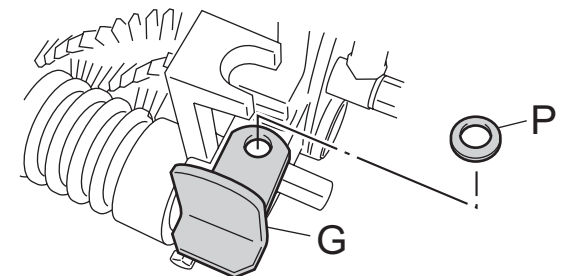

## Step 14.

Screw short threaded leg of roller adjuster screw, Part (M) through Parts (O), (G), (P), and then into frame. When doing so, align roller adjuster, Part (N) so that it sits in forked tongue of the left roller bracket arm. Make sure that Part (G) is centered then lock and tighten Part (M) being mindful of the roller adjuster, Part (N) position.

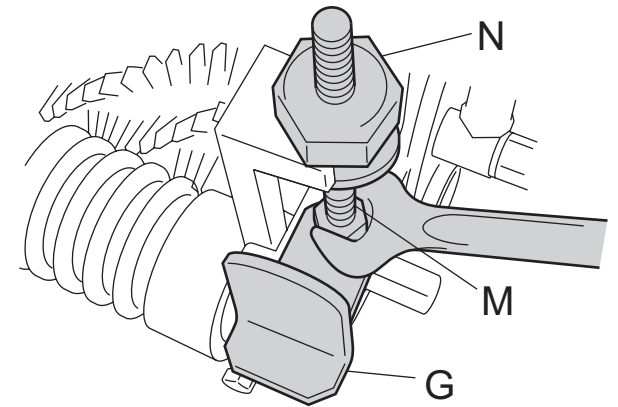

## Step 15.

Slide one cotter pin, Part (K) into hole near top of shaft, Part (I). Bend the legs of the cotter pin, Part (K) around shaft, Part (I) to lock into position. Repeat this step for remaining shaft, Part (I).

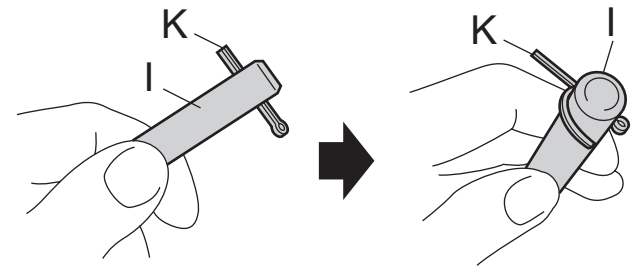

## Step 16.

Slide washer, Part (H) onto Part (I). Do this step for other shaft, Part (I) also.

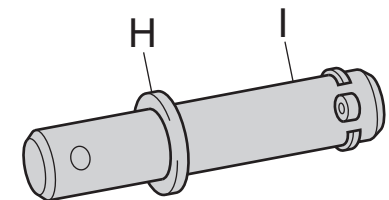

Step 17.

Align pivot arm, Part (L) into single extended arm of Part (A). Protruding arm of Part (L) should be positioned so that it is on the inside or closest to the roller side. Slide shaft, Part (I) from rear direction forward through Part (A) and then through Part (L) exiting back out of Part (A).

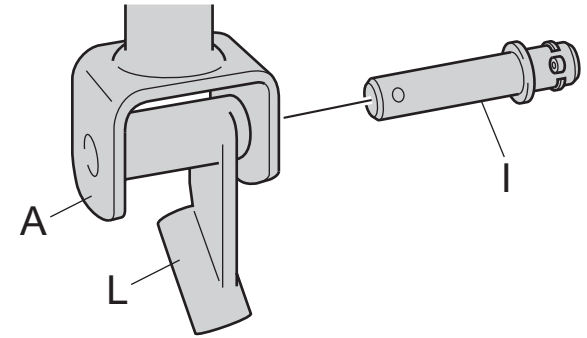

Step 18.

Slide washer, Part (H) over protruding end of Part (I), then lock Part (I) into place with snap pin, Part (J).

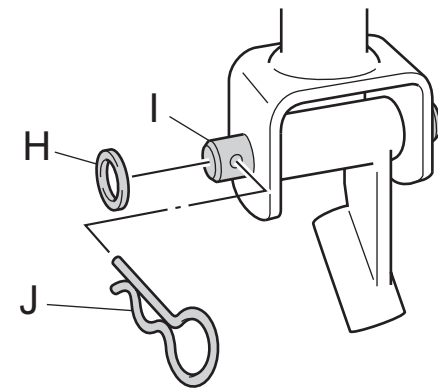

Step 19.

From front of greens mower drop catcher arm, Part (A) into position.

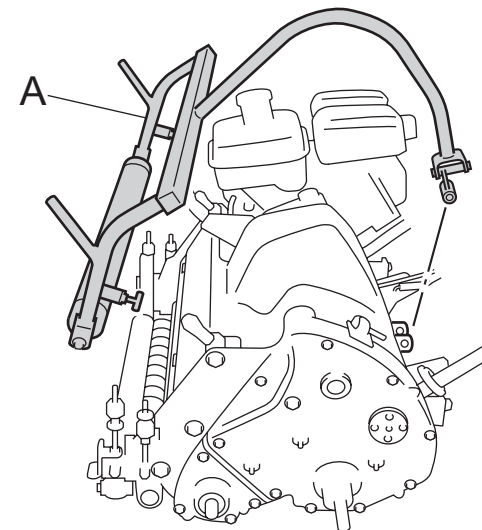

## Step 20.

Align pivot arm, Part (L) into allocated spot on rear frame of greens mower. Slide remaining shaft, Part (I) through frame starting from the left side on through Part (L) and back out the frame.

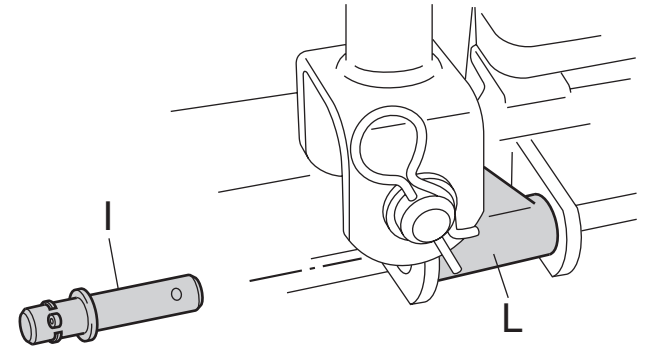

## Step 21.

Slide washer, Part (H) over protruding end of shaft, Part (I) then lock into position with Part (J).

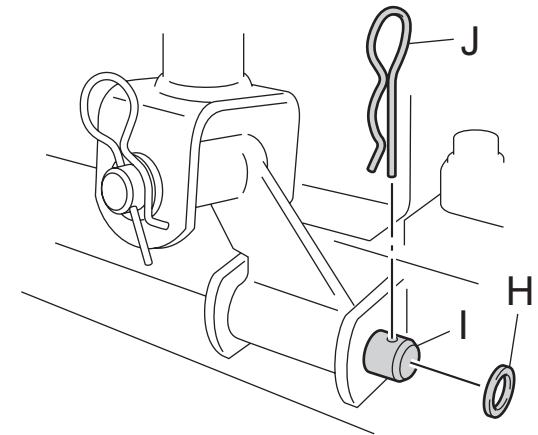

## Step 22.

Adjust distance of catcher arm, Part (A) by tightening or loosening arm stoppers, Part (E). You want a slight space between the arm stopper, Part (E) and stopper brackets, Parts (F) and (G). The distance of the roller should be even on both sides.

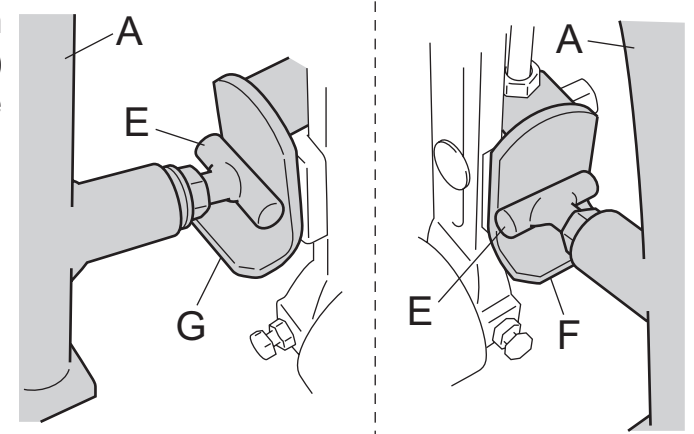

Step 23.

Lock arm stopper, Part (E) into desired position by tightening and locking down flange nuts, Part (D) on both sides.

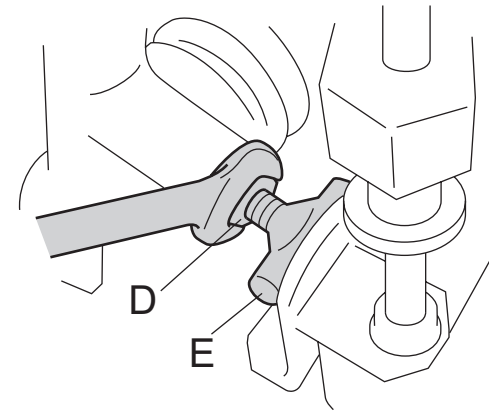

Step 24.

Stick logo sticker, Part (S) on grass catcher, Part (Q). Stick alignment mark, Part (R) in indicative positions for operational support.

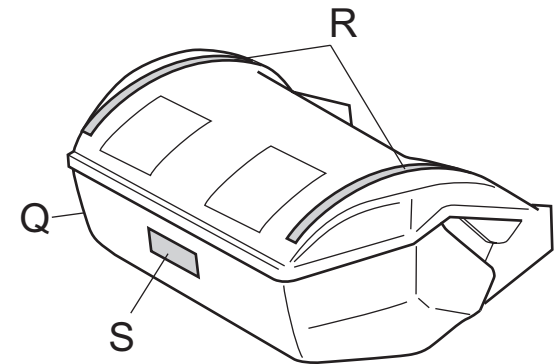

Step 25.

Place grass catcher, Part (Q) onto independent arm, Part (A).

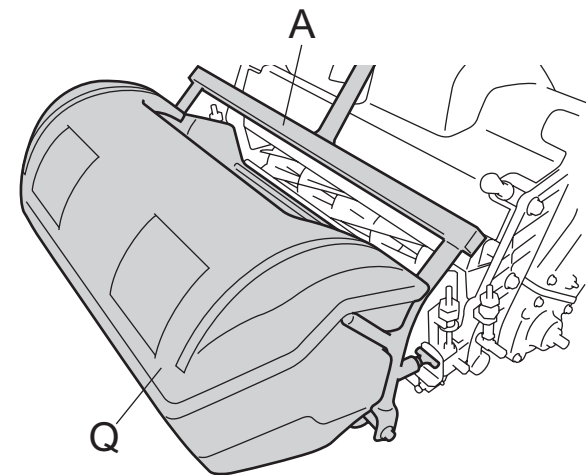

**BARONESS**<sup>®</sup>

Kyoeisha USA, Inc.  
1301 Rand Street, Suite D • Petaluma, CA 94954  
Phone: 707.283.0610 • Fax: 707.283.0613  
Web: [www.baroness.us](http://www.baroness.us)